

序号/RevNo.      名称/Title      文件编号/File No.

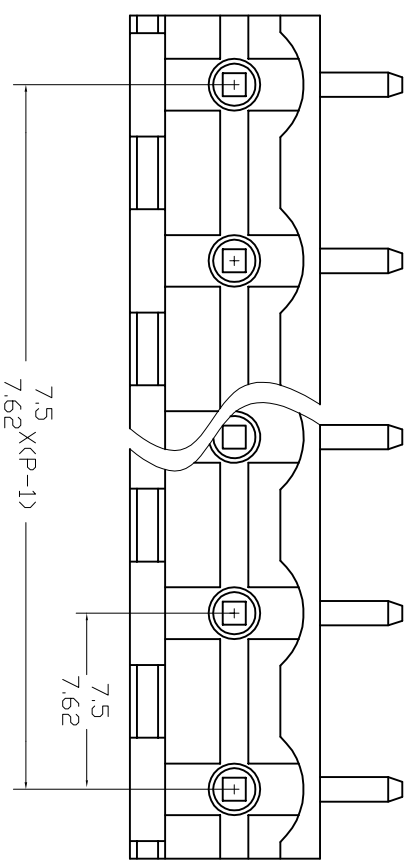
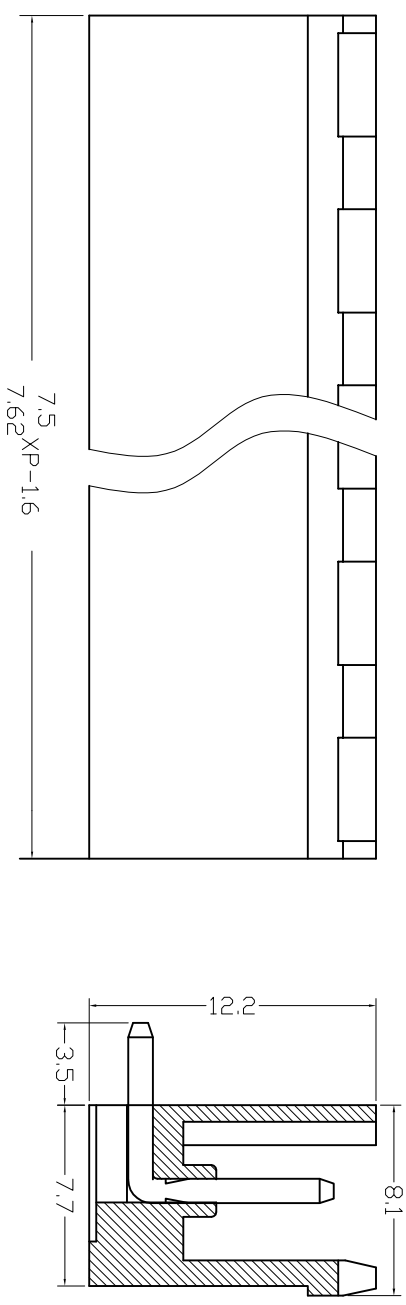

300V 15A  
 Poles: 2-12P  
 Pitch: 7.5mm(.295"), 7.62mm(.300")  
**Materials**  
 Housing: PA66  
 Solder Pin: Brass, Tin Plated.

序号/RevNo.      更改记录/Revision note      签名/Signature      日期/Date

设计/Designed by	绘图/Drawing by	审核/Checked by	批准/Approved by	备注/Remark		单位/Units: mm	
				XY2500R-M XY2500R-N		General Tolerance	
				图名/File name	文件编号/File No.	X. ° ±2°	X. ° ±1°
				XY2500R-M		.X ±0.1	.X ±1°
				XY2500R-N		.xx ±0.05	.xx ±0.5°
				页序/Sheet		.xxx ±0.01	

