

# Specification

<b>Customer</b>		<b>Name</b>	Proximity switch	<b>Type</b>	MR3210
-----------------	--	-------------	------------------	-------------	--------

## Movement explanation

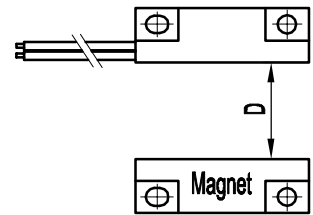
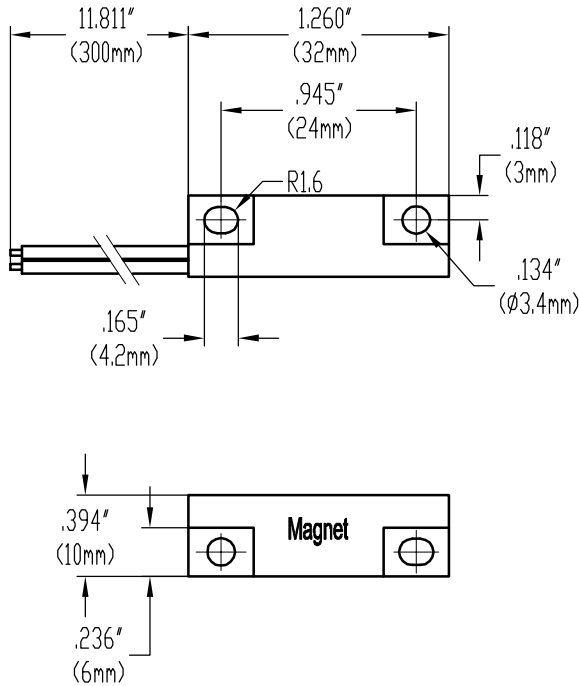

**Movement explanation :**  
When  $D=18\pm 1\text{mm}$ , the reed switches will be closed

Material Specification			Electrical Specification			Physics Specification		
<b>Part name</b>	<b>Specification</b>	<b>Quantity</b>	1.contact form	A(N.O.)		1.min resistance to vibration value	(11-1000HZ)	
1.Magnet	Ferrite	Optional	2.contact rating	10W		2.applicable temperature	-10 ~ +85°c	
2.float body	ABS	1PC	3.max switching current	DC100/AC100				
3.cap nut	—	—	4.breakdown voltage	150min				
4.o-ring	—	—	5.max switching voltage	DC0.5				
5.e-ring	—	—	6.max carry current	1.0A				
6.wire	UL 1007 24# black	300mm	7.contact resistance	100max				
7.filling	epoxy glue	—	8.insulation resis tance	10 <sup>4</sup> min				
8.terminal	—	—	9.get an electric shock life	10 <sup>7</sup>				
9.housing	—	—	designed by:	checked by:	drawing by:	drawing date:	scale:	
10.reed switch	324	1PC						

**Ningbo Holleywin Export&Import Trade Co., LTD.**

filename:

drawing no.

edition:

sheet:

1