

Specification

Customer		Name	Proximity switch	Type	MR-5C-48
-----------------	--	-------------	------------------	-------------	----------

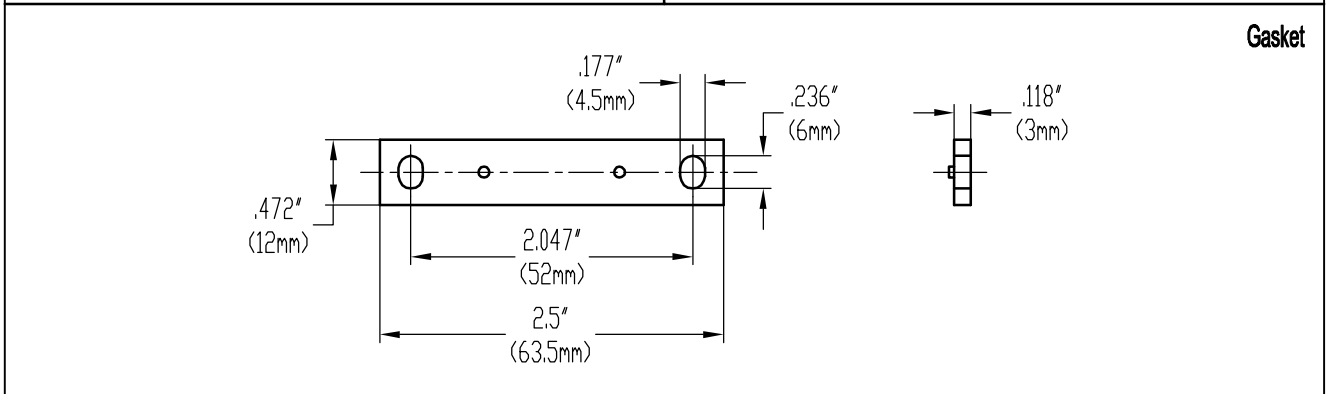
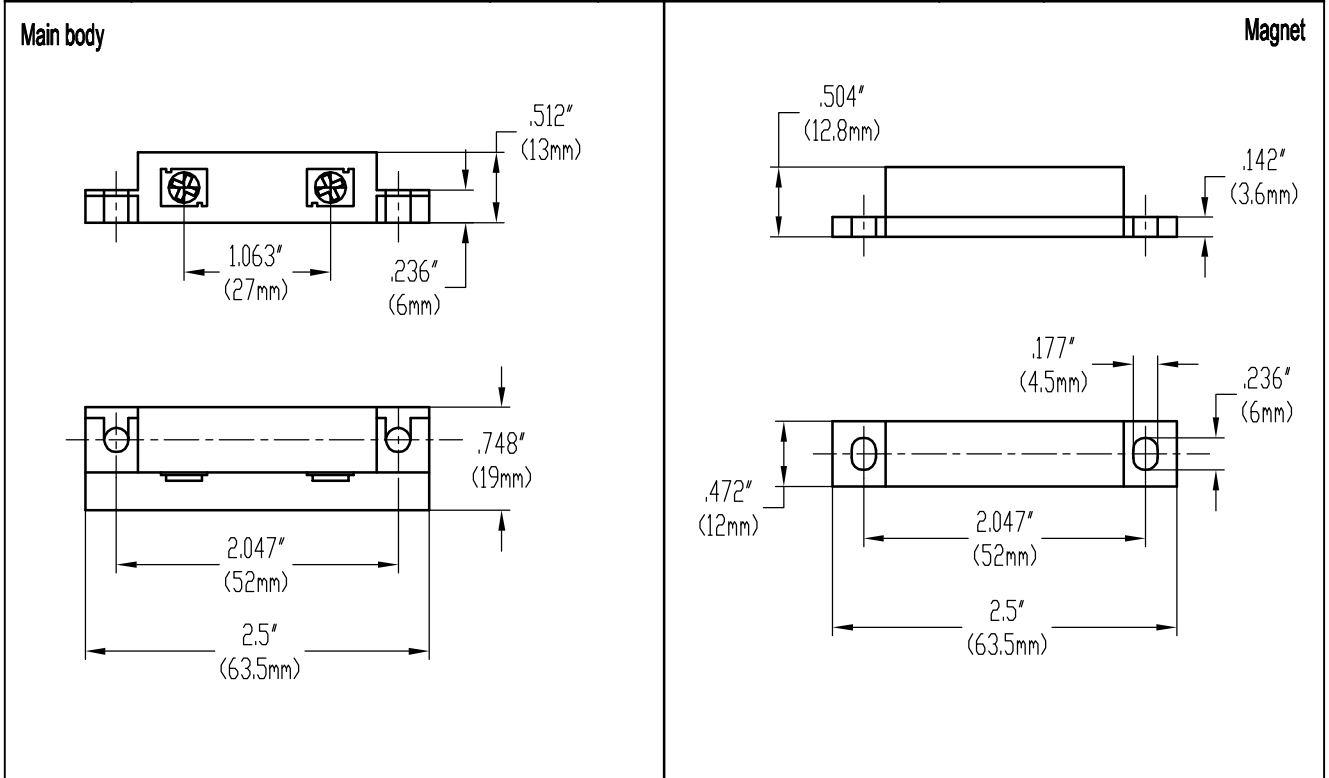

Material Specification			Electrical Specification		Physics Specification	
Part name	Specification	Quantity	1.contact form	NC	1.min resistance to vibration value (11-1000HZ)	
1.Magnet	—	1PC	2.contact rating	10W	2.applicable temperature -10 ~ +85°c	
2.main body	ABS	1PC	3.max switching current	DC100/AC100	3.induction distance 30 ~ 40mm	
3.magnet shell	ABS	1PC	4.breakdown voltage	150min		
4.o-ring	—	—	5.max switching voltage	DC0.5		
5.gasket	ABS	1PC	6.max carry current	1.0A		
6.wire	Sheath line	500mm	7.contact resistance	100max		
7.filling	—	—	8.insulation resistance	10 ⁹ min		
8.terminal	—	—	9.get an electric shock life	10 ⁷		
9.housing	—	—	designed by:	checked by:	drawing by:	drawing date:
10.reed switch	324	1PC				scale:

Ningbo Holleywin Export&Import Trade Co., LTD.	filename:		
	drawing no.	edition:	sheet: 1