

Specification

Customer		Name	Side mounted liquid level switch	Type	MR-L9-SS-2A
----------	--	------	----------------------------------	------	-------------

Movement explanation

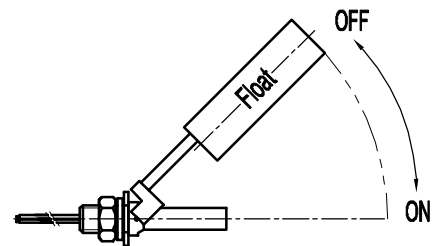
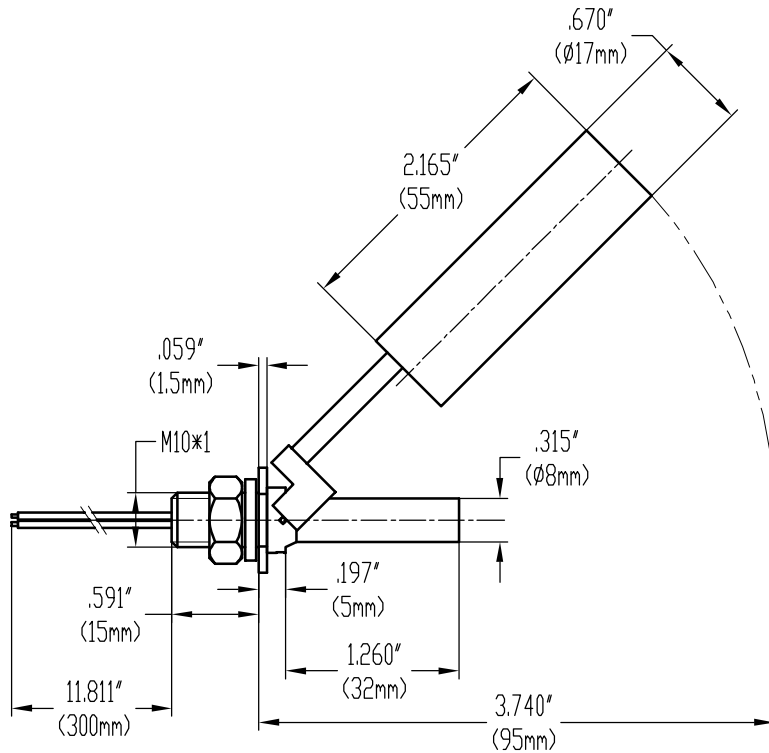

Movement explanation:

1. when the float is in $20 \pm 2^\circ$, the reed switch will be closed.
2. when the float is in $25 \pm 2^\circ$, the reed switch will be open.

Material Specification			Electrical Specification			Physics Specification			
Part name	Specification	Quantity	1.contact form		A(N.O.)	1.float pressure		$\leq 0.7\text{MPa}$	
1.float ball	SUS304	1PC	2.contact rating		50W	2.min resistance to vibration value		(11-1000HZ)	
2.float body	SUS304	1PC	3.max switching current		DC350/AC300	3.applicable temperature		-15 ~ +125°C	
3.cap nut	SUS304	1PC	4.breakdown voltage		600min				
4.o-ring	rubber	1PC	5.max switching voltage		DC0.7/AC0.5				
5.e-ring	—	—	6.max carry current		2.5A				
6.wire	1015 22# black	300mm	7.contact resistance		100max				
7.filling	epoxy glue	—	8.insulation resistance		10 ⁹ min				
8.terminal	—	—	9.get an electric shock life		10 ⁷				
9.housing	—	—	designed by:	checked by:	drawing by:	drawing date:	scale:		
10.reed switch	229	1PC							

<h2 style="margin: 0;">Ningbo Holleywin Export&Import Trade Co., LTD.</h2>	filename:		
	drawing no.	edition:	sheet: 1